

# MDS 200 Compact Feeder

## Ultra-compact dosing unit

MDS 200 Compact Feeder is an ultra-compact dosing unit, especially developed for small injection molding machines. Its small size and the accurate stepper motor drive enable you to dose additives in-line on the smallest machines on the market.

You can use the MDS 200 Compact Feeder for normal granulates and micro granulates. It is equipped with a quick release coupling, allowing easy color change. For different small injection molding machines we have adapters available.

The MDS 200 Compact Feeder comes with a MC12 controller. The masterbatch hopper has a volume of 200 ml. The unit can also be supplied with an optional integrated hopper loader for the main material and MC18 controller. The main material hopper can contain 1.8 liter.

Reliable additive dosing on the smallest machines, the MDS 200 Compact Feeder is designed to do just that.

### Features

- ▶ Ultra small, but robust design
- ▶ Quick and easy color changes
- ▶ Optional: integrated main material hopper loader



### MDS 200 Compact Feeder MC12

- ▶ Manual adjustment of metering speed and time
- ▶ Relay mode for extrusion applications
- ▶ Keypad lock function
- ▶ 4-piece 7 segments LED display
- ▶ Keypad operated

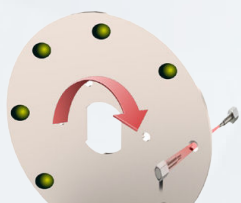

### MDS 200 Compact Feeder MC18

- ▶ Manual adjustment of metering speed and time
- ▶ Auto synchronization to extruder speed
- ▶ Integrated main material hopper loader control
- ▶ Alarm output
- ▶ Keypad lock function
- ▶ 4-piece 7 segments LED display
- ▶ Keypad operated



# GET IN TOUCH TODAY

We solve the most technically advanced plastics automation problems across all industries.



+44 (0) 1827 265 800

info@summitsystems.co.uk

www.summitsystems.co.uk

# MDS 200 Compact Feeder

## Ultra-compact dosing unit



### Technical Specifications

#### Capacity

- 0.05-1.0 g/sec\*

#### Applications

- Injection molding

#### Power Supply

- 80-260 VAC, 50/60 Hz. By integrated automatic voltage selector

#### Power Consumption

- 80 Watt maximum

#### Operation

- MC12 Micro and MC18 Micro: keypad

#### Input Signals

- Start input: potential free, 24 VDC or extruder tach (0-30 VDC) (tach only for MC18)

#### Output Signals

- MC18 Micro: alarm, valve (for automatic main material hopper loader)

\* measured with a bulk density of 0.8 kg/dm<sup>3</sup>

### Dimensions

#### MDS 200 Compact Feeder MC12

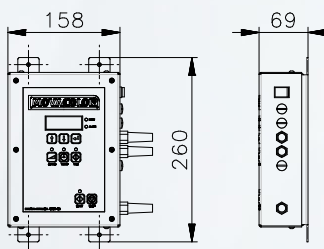
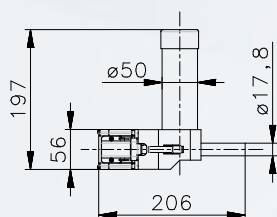
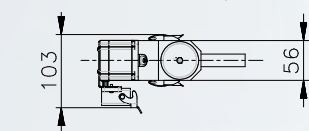

### Dimensions

#### MDS 200 Compact Feeder MC18 with main hopper and loader

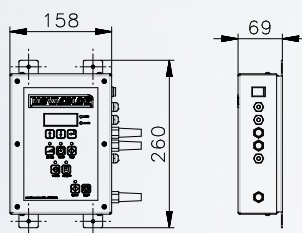
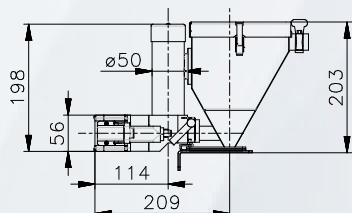
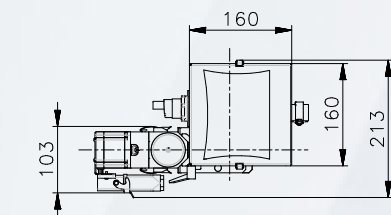

+44 (0) 1827 265 800

info@summitsystems.co.uk

www.summitsystems.co.uk