

Incline Conveyors

N-CPST Conveyor with Paddle Separator



These aesthetically pleasing Incline Conveyors with Paddle Separator from MB Conveyors are formed by 6 orange PVC flaps assembled on an aluminium shaft, keyed to the gearmotor. The working height of the separators with respect to the belt surface can be adjusted from 0 to 180mm.

Fixed standard conveyor speed 4.5m/min.

Standard motor supply voltage 400 volts/50Hz.



Main characteristics:

- Standard configuration with unloading chute, separator on the left and double Start and Stop switch/motor protector (one for the conveyor and one for the separator)
- To ensure the separator functions in the best possible way, the conveyor requires:
 - Standard cut-proof, oil-proof belt in green textured PVC (ref. Pantone 320) without slats; vulcanized belt joint
 - Min and max withstand temperature: from -10 to +60°C
 - Recommended maximum incline: < 30°

Separator Drive Unit:

- Power: 0.09 kW
- Speed: 70 rpm
- Voltage: 400 V / 50 Hz

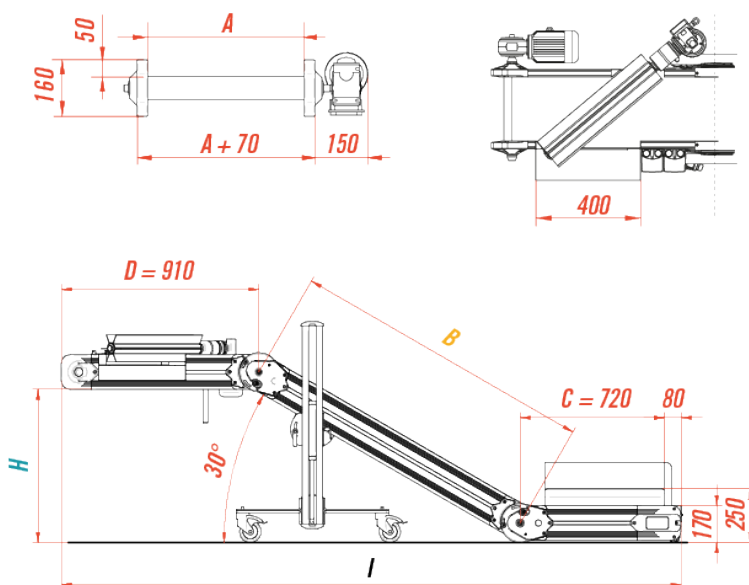

SEPARATION PRINCIPLE - OPERATING SCHEME

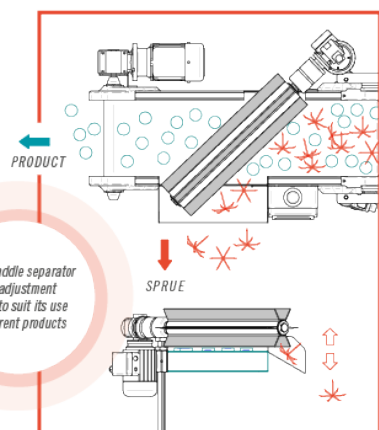

	A	B	H (30°)	I (30°)
N-CPST.0	140 mm	1300 mm	650 mm	2850 mm
N-CPST.1	240 mm	1300 mm	650 mm	2850 mm
N-CPST.2	340 mm	1800 mm	900 mm	3250 mm
N-CPST.3	440 mm	1800 mm	900 mm	3250 mm

Incline Conveyors

N-CPST Conveyor with Paddle Separator



Examples of positioning beside the Injection Moulding Machine

Standard Lateral Position

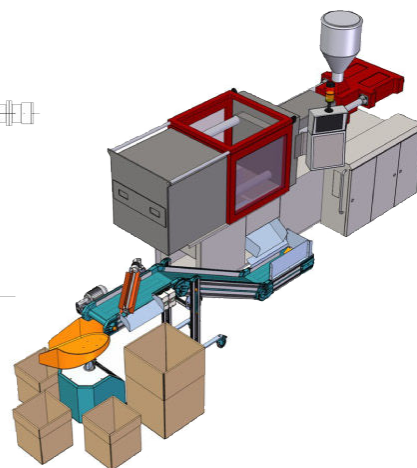
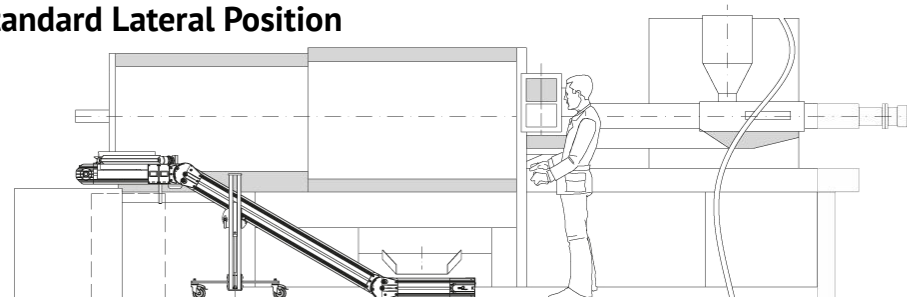

Positioning at right angles under press

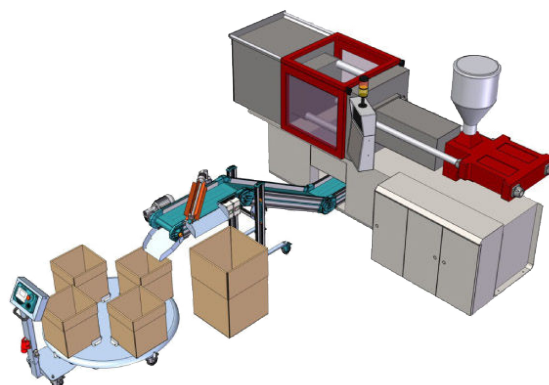
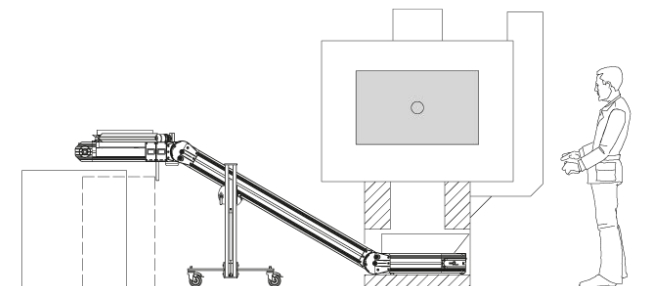

Longitudinal positioning under press

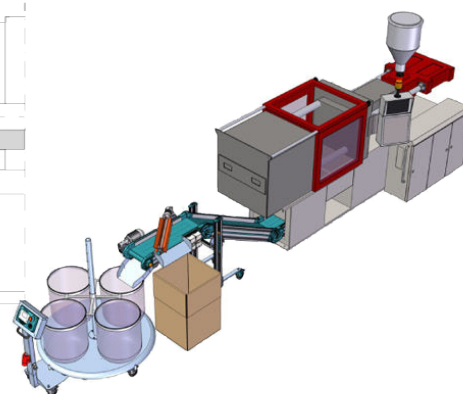
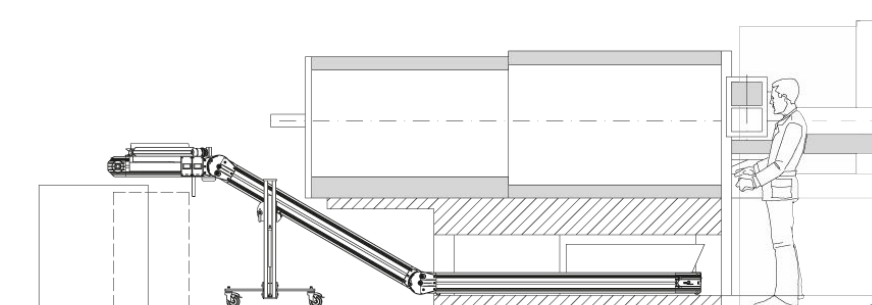

Incline Conveyors

N-CPST Conveyor with Paddle Separator



N-CPST conveyor in easy-line version

- N-CPST conveyor demonstrated complete with paddle separator for removing sprues.
- It is fitted with a textured PVC belt without slats. The incline angle of the upward section should be 30-35°.



Flap separator installed on Flat Conveyor (N-PA)

- Image shows a paddle separator installed on a flat conveyor.
- This conveyor is usually positioned at right-angles to a loading conveyor.

Conveyor N-CPST with textured belt complete with 8x8mm feed dog

- This solution is used when the textured belt alone is unable to guarantee the required conveying capacity owing to the conformation of the product and/or sprue. Application of a feed dog, which usually measures 8x8mm, ensures smooth conveying without impairing the separation capacity.
- Conveying/separation trials in the MB factory with products and sprues at the offer stage is always the best way to ensure the solution is effective.

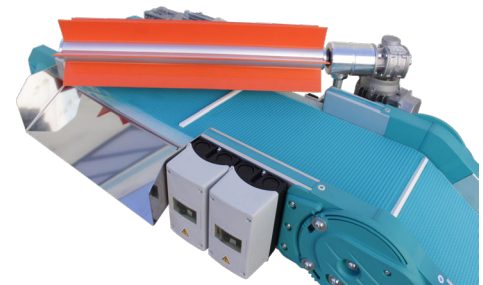

N-CPST complete with Double Flap Separator

- This solution is proposed when a multiple-cavity mould is used and, besides being separated from the sprues, products of different sizes from the same moulding operation must also be separated.
- The minimum length of the flat upper section of the N-CPST conveyor with double paddle separator is 1100mm.
- To ensure that the conveyor operates in the best possible way, it is advisable to test it with the product to be conveyed before it is consigned.